

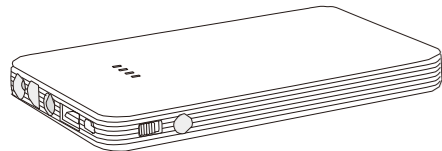

USER MANUAL

Thank you for choosing the jump starter! Always follow basic safety precautions when using electrical appliances. Read all instructions carefully, please keep this instruction manual for easy reference.



Model: CP-07

①

A. PRODUCT LAYOUT:

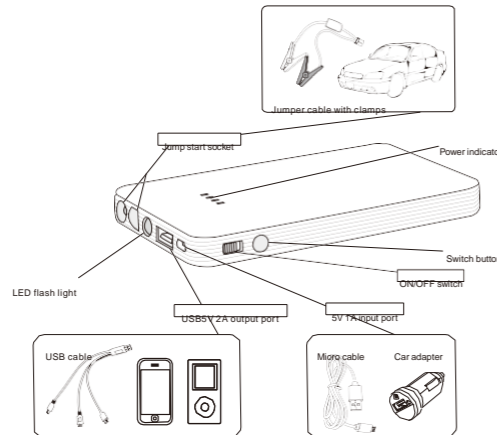

B. OPERATION GUIDANCE

Indicator

Turn on the on/off switch and press the switch button to check the storage level of jump starter.

Indicator	1 Solid	2 Solid	3 Solid	4 Solid
Storage level	25%	50%	75%	100%

The indicator will flash one by one during the period of charging. Different number of solid indicators show different storage level of jump starter. All indicators light up when the charging is paused or completed.

②

Jump starter charging instruction:

1. Plug the micro cable to electronic devices with USB output.
2. Connect 5V/1A input port of jump starter to start charging.

Or

1. Plug the car adaptor into the socket of cigarette lighter.
2. Connect 5V/1A input port of jump starter to the other end of car adaptor.

Note: Do not charge the jump starter unit immediately after starting engines, but at least 30 minutes later.

Warning:

Make sure recharge the unit every 3 months if no use, otherwise, the inside battery will be damaged!



Jump start 12V vehicle instruction:

1. Make sure that the number of indicator is not less than 3, fully charged is suggested.
2. Plug the cord of jumper cable into the jump start socket.
3. Connect the RED clamp to the vehicle's battery positive (+) terminal and connect The BLACK clamp to the vehicle's battery negative(-) terminal.
4. Start the vehicle, and interval time between each starting attempts must be OVER 30 seconds. If after 3 times failure, stop trying again; please check if there are problems of the vehicle engine or circuit, meanwhile, check the jump starter, if problem, please return it to the distributor.
5. When the vehicle is started, remove jumper cable from jump starter and disconnect red and black clamps to the vehicle battery terminals within 30 seconds.
6. Leave the vehicle's engine running.



③

Charging cell phone or tablet instruction:

1. Plug the switch cable to USB 5V 2A output port.
2. Select appropriate connector for your mobile phones or tablet and connect it to your mobile phone or tablet.
3. Turn on the on/off switch and press the switch button to charge.



LED Flash Light

Turn on the on/off switch and press the switch button 3 seconds to start the LED light. There are 3 modes for LED light appear in order (illumination, strobe, SOS) if you press lightly.

C. PARTS LIST

#	Parts Name	Quantity	#	Parts Name	Quantity
1	Jump starter unit	1	5	USB cable	1
2	Jumper cable with clamps	1	6	User manual	1
3	Micro cable	1			
4	Car adaptor	1			

D. TECHNICAL SPECIFICATIONS:

Size: 135*76*16mm
Weight: 225g
Battery Capacity: 5400mAh
Input: 5V/1A
Output: 5V/2A; 12V jump start
Full charging time: approx. 7h
Start current: 200A
Peak current: 300A
Operation temp.: -20°C ~ 60°C / -4°F ~ 140°F
Protections: Short circuit proof, over charge protection and discharge protection
Lifetime: >1000 cycles

④

E. FAQ:

Q. How to turn off this appliance?

A. When it's not used, you can adjust the on/off switch to off position to turn off it.

Q. How many times can this appliance charge for my mobile phone?

A. 3 times for iphone mobile phone.

Q. How long will this appliance take to fully charge a mobile phone?

A. Approx. 1 hour.

Q. How many times can this appliance on a full charge to start the vehicle?

A. Approx. 20 times.

Q. How long will the Jump Starter's battery stay charged?

A. 3 months.

F. TROUBLE SHOOTING

Finding	Cause	Remedies
No response when pressing the switch button	Low voltage protection of Jump Starter is started	Plug the adaptor into the 5V 1A input port to activate

⑤

G. TOXIC AND HARMFUL SUBSTANCES

Composition and amount of toxic and harmful substances in Jump Starter					
Pb	Hg	Cd	Cr(VI)	PBB	PBDE
0	0	0	0	0	0

0: Indicate all homogeneous material's hazardous substances content are below the MCV limit specified in the standard 2011/65/EU (RoHS)

⑥

H. WARNING:

1. Do not make the blue plug into the jump starter socket tightly when jump start the vehicle. If not, it can't jump start the vehicle, and even make the joint melt.
2. Do not check whether the battery clamps well connected; battery connector rusted, dirty if the vehicle can not be started. Jump start again after cleaning. Do not continue to jump start if 3 times not successfully. If not, it will damage the product. Do check the vehicle for other reasons.
3. Do not remove the product from the vehicle within 30s. After the vehicle started. If not, it may lead dangerous!
4. Do not connect the two clamps. If not, it may lead dangerous.
5. Do not decompose product. If not, it may lead dangerous.

Always take care when using the appliance

- ⚠ This appliance is not intended for use by young or infirm persons without supervision. Do not use as a toy.
- ⚠ Do not allow the appliance to become wet .
- ⚠ Do not immerse the appliance in water .
- ⚠ Do not operate the appliance in explosive atmospheres, such as in the presence of flammable liquids, gases or dust .
- ⚠ Do not modify or disassemble Jump starter. Only a suitably qualified technician may repair this unit.
- ⚠ Do not expose the appliance to heat .
- ⚠ Do not store in locations where the temperature may exceed 70°C.
- ⚠ Charge only at ambient temperatures between 0°C- 60°C.
- ⚠ Charge only using the charger provided with the appliance .
- ⚠ Under extreme conditions, battery leakage may occur. Carefully wipe the liquid off using a cloth and avoid skin contact when you notice liquid on the batteries. In case of skin or eye contact, rinse immediately with clean water and seek medical attention.
- ⚠ At the end of its useful life, discard the appliance with due care for our environment .

⑦

I. WARRANTY INFORMATION:

1. We offer a limited warranty for this product against any defects in material and workmanship for a period of 12 months since the date of the factory. The conditions of the warranty are as follows.
2. The warranty is only valid upon presentation of the original receipt (from dealer/retailer) by the original purchaser with the product to be repaired or replaced.
3. The warranty is invalid if the serial number, date of purchase and label has been removed.
4. The warranty does not cover damage or product failure resulting from normal wear and tear, physical abuse, improper installation, modification or repairs by unauthorized third parties.
5. We do not assume responsibility for any loss or damage incurred during shipment or as a result of a force majeure.
6. We are not liable for any incidental or consequential damages arising from the use or misuse of the product.
7. All warranty claims are limited to repair or replacement of defective product and at the sole discretion of us.
8. If we repair or replace the product, the product will be covered for the remaining time of the original warranty period. Repair or replacement may involve the use of reconditioned units which are equivalent in function. Replaced part or product becomes the property of us.
9. Consumable components such as batteries and accessories are not covered by the warranty.



Overcharge and Overdischarge Protection



Fuse Protection



Against-reverse Plug



⑧